

2 Cromwell Gardens, Scarborough

£180,000

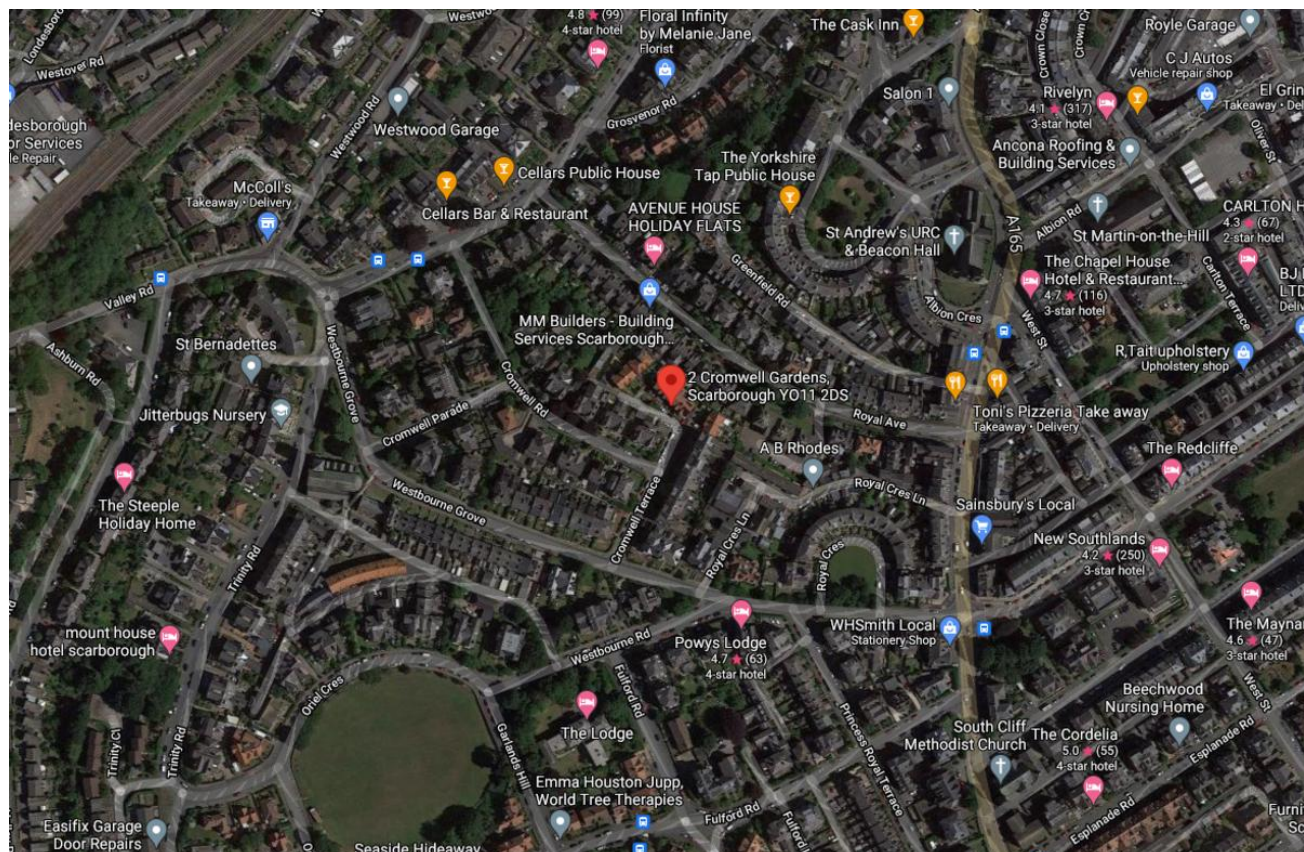

Full EPC information available on request.

- Semi detached home
- 2 Reception rooms
- 2 Bathrooms
- 3 Bedrooms and loft room
- Private enclosed outside space
- Gas central heating
- Double glazed windows
- No onward chain

Please note that under the Property Misdescriptions Act 1991 we have endeavoured to make these particulars as reliable and accurate as possible but their accuracy is not guaranteed and they do not form part of any contract as they are prepared as a general guide. We have not carried out a detailed survey or tested any of the appliances, services or specific fittings. Room sizes should not be relied upon for carpets and furnishings. Internal photographs are intended as a guide only and it should not be assumed that any furniture/fittings are included in the sale. Where shown details of the lease, ground rent and service charge have been provided by the vendor and their accuracy cannot be guaranteed. The buyer is advised to obtain verification from their Solicitor or Surveyor.





**Spacious SEMI DETACHED home with 3 BEDROOMS AND LARGE ATTIC ROOM, 2 BATHROOMS and 2 RECEPTION ROOMS. Offered for sale with NO ONWARD CHAIN.**

The property briefly comprises of an entrance hallway with under stairs storage cupboard. The sitting room is positioned to the front of the home and has bay window and feature fireplace, separate dining room with feature fireplace and sliding patio doors opening onto the private rear garden. The kitchen is fitted with a range of wooden units and has space for an oven, washing machine, tumble drier and 2 under counter appliances, door opening onto rear garden space. To the first floor is the master bedroom with bay window, a second double sized bedroom and a third bedroom of generous single size. The family bathroom is fitted with a white suite and comprises bath with shower over, bidet, toilet and sink. Stairs to the second floor with a large loft room with 2 velux windows, currently used as a bedroom and a further bathroom with bath, shower above, toilet, sink and bidet. To the outside of the home is a small garden to the front and a generous sized private garden space to the rear.

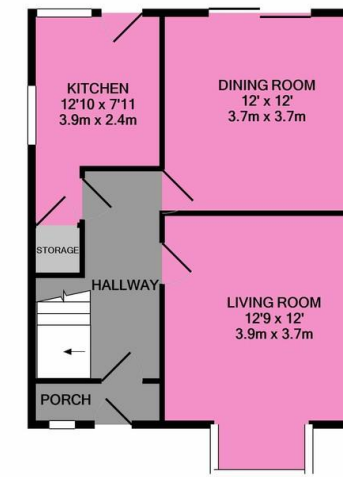

GROUND FLOOR

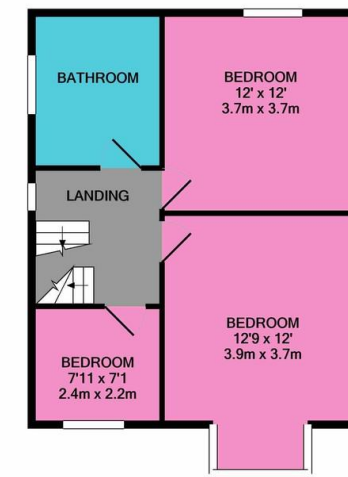

1ST FLOOR

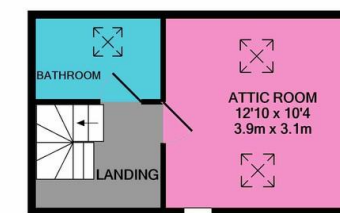

2ND FLOOR

Whilst every attempt has been made to ensure the accuracy of the floor plan contained here, measurements of doors, windows, rooms and any other items are approximate and no responsibility is taken for any error, omission, or mis-statement. This plan is for illustrative purposes only and should be used as such by any prospective purchaser. The services, systems and appliances shown have not been tested and no guarantee as to their operability or efficiency can be given.  
Made with Metropix ©2021